

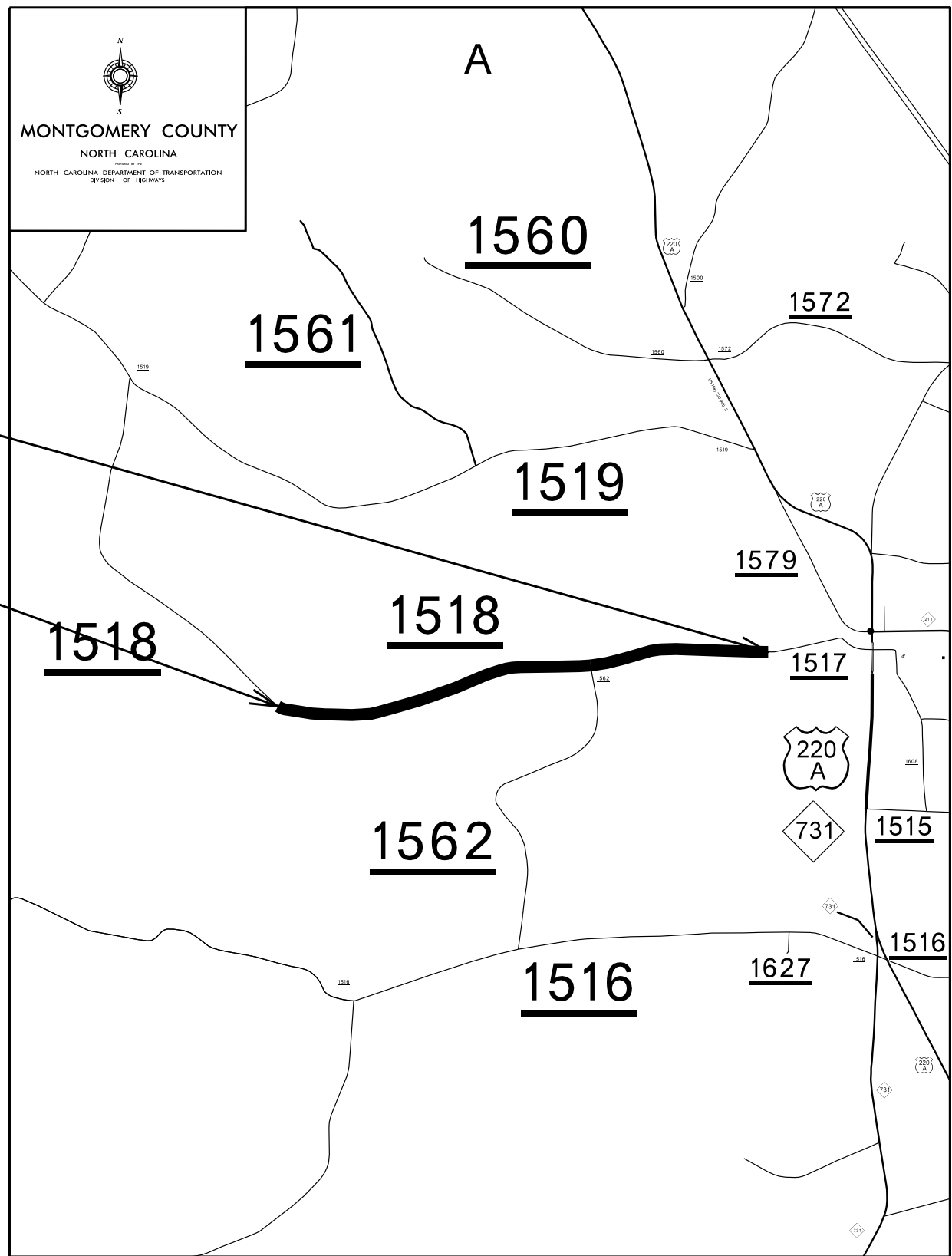

MONTGOMERY COUNTY

040397
 2025-OCT-2024 11:58
 Montgomery November 2024 - AST Montgomery November 2024 - Map - Typ.dgn
 2025-08-05 10:03:34

Map 1





MONTGOMERY COUNTY
 NORTH CAROLINA
NORTH CAROLINA DEPARTMENT OF TRANSPORTATION
 DIVISION OF HIGHWAYS

1

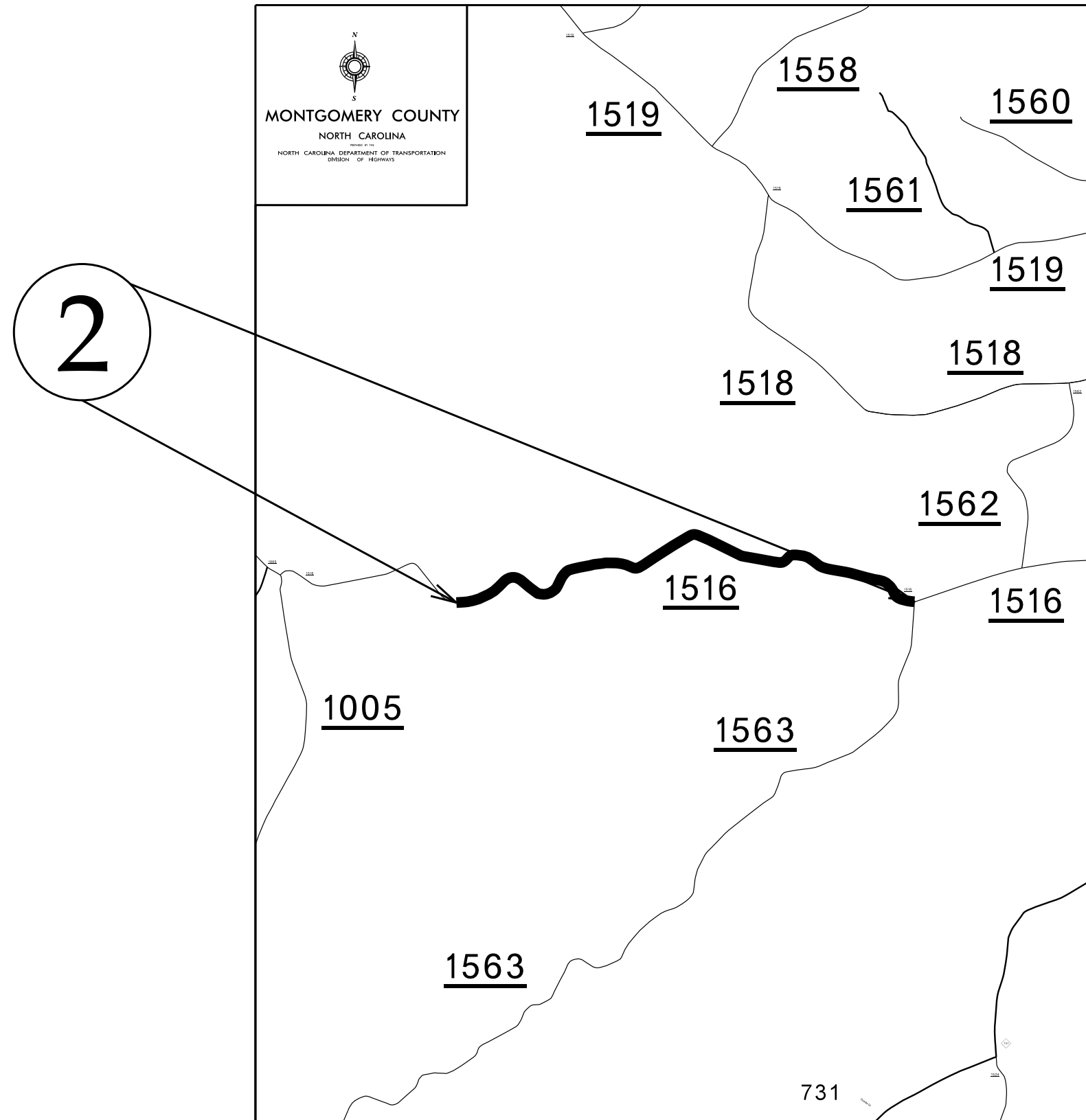
Map 2

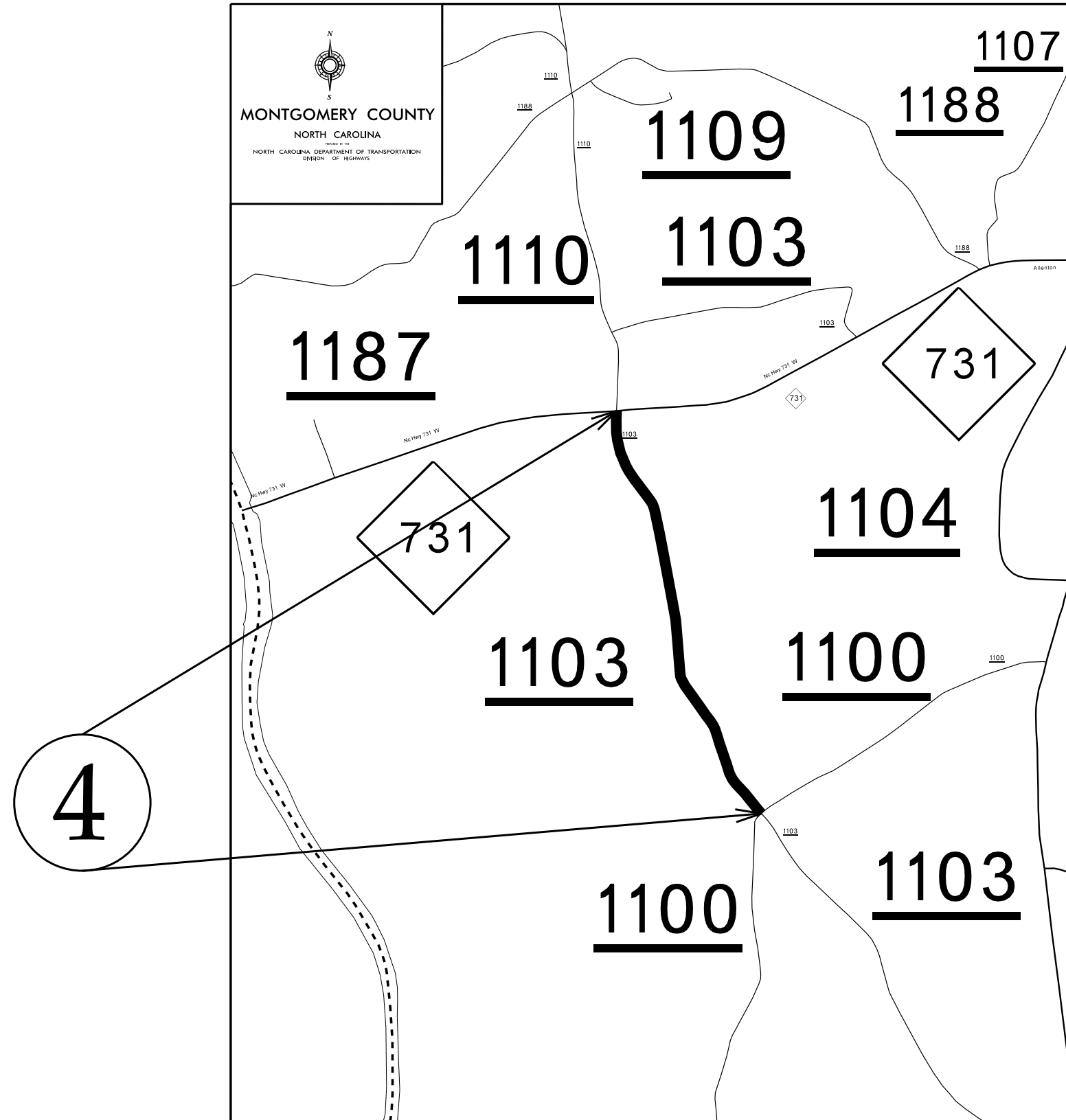

Map 4



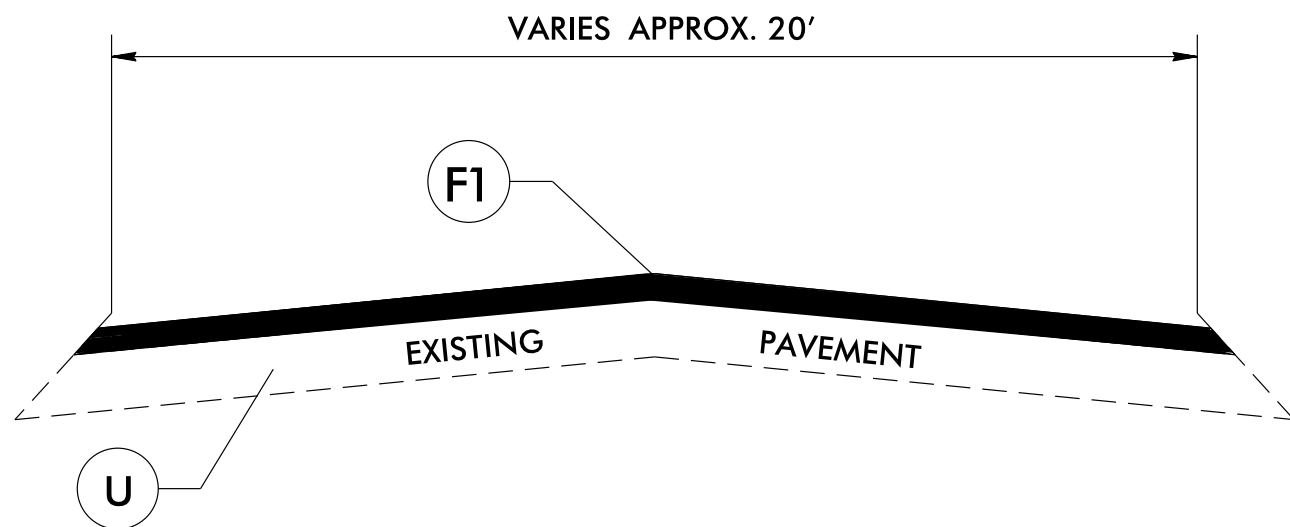

TYPICAL SECTION NO. 1

| PAVEMENT SCHEDULE | |
|-------------------|---|
| F1 | PROP. ASPHALT SURFACE TREATMENT DOUBLE SEAL |
| U | EXISTING PAVEMENT |

| | | |
|---------------------|-----------|-----------|
| PROJECT NO. | SHEET NO. | TOTAL NO. |
| 2025CPT.08.05.20622 | 7 | |

SUMMARY OF QUANTITIES

| PROJECT NO | COUNTY | MAP NO | ROUTE | DESCRIPTION | TYP NO | LANES | LANE TYPE | LENGTH | WIDTH | BEGI | END | 1575000000-E | 1704000000-E | 1803500000-E | 1838000000-E | 1838500000-N | |
|---|------------|--------|---------------------------------|---|--------|-------|-----------|-------------|-------|------|------|------------------------------|----------------------------|--|--|--------------|-------------|
| | | | | | | | | MI | FT | N MP | MP | ASPHALT BINDER FOR PLANT MIX | PATCHING EXISTING PAVEMENT | ASPHALT SURFACE TREATMENT, DOUBLE SEAL | EMULSION FOR ASPHALT SURFACE TREATMENT | VACUUM TRUCK | |
| | | | | | | | | | | | | TONS | TONS | SY | GAL | WK | |
| 2025CPT.08.05.20622 | Montgomery | 1 | SR-1518 / CURRIE RD | FROM MCCALLUM ST. (NON SYSTEM) TO 1.30 MILES WEST OF SR 1562 (MCCALLUM POND RD) | 1 | 2 | 2WU | 2.17 | 20 | 0.18 | 2.35 | 1 | 20 | 25,500.00 | 14,025 | * | |
| TOTAL FOR MAP NO. 1 | | | | | | | | 2.17 | | | | 1 | 20 | 25,500.00 | 14,025 | | |
| 2025CPT.08.05.20622 | Montgomery | 2 | SR-1516 / MCCALLUM RD | FROM SR 1563 (LOVIN HILL RD) TO PERRY DR (PRIVATE DRIVE) | 1 | 2 | 2WU | 3.17 | 20 | 2.55 | 5.72 | 1 | 20 | 37,200.00 | 20,460 | | |
| TOTAL FOR MAP NO. 2 | | | | | | | | 3.17 | | | | 1 | 20 | 37,200.00 | 20,460 | | |
| 2025CPT.08.05.20622 | Montgomery | 3 | SR-1533 / CEMETERY RD | FROM RICHMOND CO (US-220 ALT) TO SR 1575 (YARBOURGH RD) | 1 | 2 | 2WU | 2.35 | 20 | 0 | 2.35 | 1 | 30 | 27,600.00 | 15,180 | | |
| TOTAL FOR MAP NO. 3 | | | | | | | | 2.35 | | | | 1 | 30 | 27,600.00 | 15,180 | | |
| 2025CPT.08.05.20622 | Montgomery | 4 | SR-1103 / THOMASVILLE CHURCH RD | FROM SR 1100 (MCKAY HILL RD) TO NC 731 | 1 | 2 | 2WU | 1.4 | 20 | 1.57 | 2.97 | 1 | 30 | 16,500.00 | 9,100 | | |
| TOTAL FOR MAP NO. 4 | | | | | | | | 1.4 | | | | 1 | 30 | 16,500.00 | 9,100 | | |
| TOTAL FOR PROJ NO. 2025CPT.08.05.20622 | | | | | | | | 9.09 | | | | 4 | 100 | 106,800.00 | 58,765 | | 5.00 |
| GRAND TOTAL | | | | | | | | 9.09 | | | | 4 | 100 | 106,800.00 | 58,765 | | 5.00 |

| | | |
|---------------------|-----------|-----------|
| PROJECT NO. | SHEET NO. | TOTAL NO. |
| 2025CPT.08.05.20622 | 8 | |

THERMOPLASTIC AND PAINT QUANTITIES

| PROJECT NO | COUNTY | MAP NO | ROUTE | DESCRIPTION | TYP NO | LANES | LANE TYPE | LENGTH | WIDTH | BEGIN MP | END MP | 4413000000-E | 4457000000-N | 4815000000-E | 4815000000-E | |
|---|------------|--------|---------------------------------|---|--------|-------|-----------|-------------|-------|----------|--------|---|---------------------------|----------------|-----------------|----------------|
| | | | | | | | | MI | FT | | | WORK ZONE ADVANCE/GENERAL WARNING SIGNING | TEMPORARY TRAFFIC CONTROL | 6" WHITE PAINT | 6" YELLOW PAINT | |
| | | | | | | | | | | | | SF | LS | LF | LF | |
| 2025CPT.08.05.20622 | Montgomery | 1 | SR-1518 / CURRIE RD | FROM MCCALLUM ST. (NON SYSTEM) TO 1.30 MILES WEST OF SR 1562 (MCCALLUM POND RD) | 1 | 2 | 2WU | 2.17 | 20 | 0.18 | 2.35 | 250 | * | 46,698 | 46,698 | |
| TOTAL FOR MAP NO. 1 | | | | | | | | 2.17 | | | | 250 | | 46,698 | 46,698 | |
| 2025CPT.08.05.20622 | Montgomery | 2 | SR-1516 / MCCALLUM RD | FROM SR 1563 (LOVIN HILL RD) TO PERRY DR (PRIVATE DRIVE) | 1 | 2 | 2WU | 3.17 | 20 | 2.55 | 5.72 | 360 | | 68,218 | 68,218 | |
| TOTAL FOR MAP NO. 2 | | | | | | | | 3.17 | | | | 360 | | 68,218 | 68,218 | |
| 2025CPT.08.05.20622 | Montgomery | 3 | SR-1533 / CEMETERY RD | FROM RICHMOND CO (US-220 ALT) TO SR 1575 (YARBOURGH RD) | 1 | 2 | 2WU | 2.35 | 20 | 0 | 2.35 | 265 | | 50,572 | 50,572 | |
| TOTAL FOR MAP NO. 3 | | | | | | | | 2.35 | | | | 265 | | 50,572 | 50,572 | |
| 2025CPT.08.05.20622 | Montgomery | 4 | SR-1103 / THOMASVILLE CHURCH RD | FROM SR 1100 (MCKAY HILL RD) TO NC 731 | 1 | 2 | 2WU | 1.4 | 20 | 1.57 | 2.97 | 160 | | 30,128 | 30,128 | |
| TOTAL FOR MAP NO. 4 | | | | | | | | 1.4 | | | | 160 | | 30,128 | 30,128 | |
| TOTAL FOR PROJ NO. 2025CPT.08.05.20622 | | | | | | | | 9.09 | | | | 1,035 | | 1,000 | 195,616 | 195,616 |
| GRAND TOTAL | | | | | | | | 9.09 | | | | 1,035 | | 1,000 | 195,616 | 195,616 |

SIGNING FOR ASPHALT SURFACE TREATMENT

LEGEND

- ◁ PORTABLE SIGN
- └ STATIONARY SIGN
- ← DIRECTION OF TRAFFIC FLOW

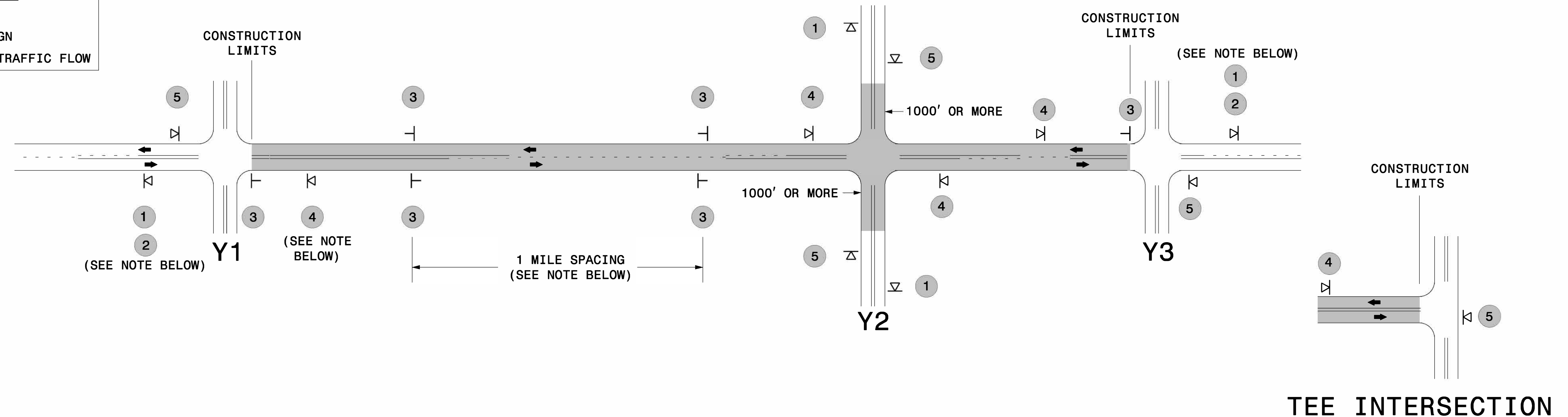

MAINLINE (-L-) SIGNING

-Y- LINE SIGNING

| | | | | |
|---|---|------|--|--|
| SIGNING NOTES AND PLACEMENT PER DIRECTION | 1 | | <ul style="list-style-type: none"> - PLACE 1000' PRIOR TO BEGINNING OF CONSTRUCTION LIMITS. ONLY USED ON -Y- LINES IF RESURFACING LIMITS EXTEND 1000' ALONG -Y- LINE. - SIGN #2 ONLY USED WHEN RESURFACING LIMITS ARE 2 OR MORE MILES IN LENGTH. ROUND UP TO THE NEAREST WHOLE NUMBER. DO NOT USE FRACTIONAL OR DECIMAL NUMBERS. | <p>STATIONARY SIGNING NOT REQUIRED FOR THE FOLLOWING -Y- LINE CONDITIONS:</p> <ol style="list-style-type: none"> 1) LESS THAN 1000' OF RESURFACING ALONG -Y- LINE 2) SUBDIVISION ROADS 3) DEAD END ROADS <p>WHEN PAVING/CONSTRUCTION ACTIVITIES PROCEED ACROSS AN UNSIGNED -Y- LINE, PORTABLE ADVANCE WARNING SIGNS SHALL BE USED ALONG THE -Y- LINE AS SHOWN BELOW. REMOVE UPON COMPLETION OF WORK.</p> <div style="display: flex; justify-content: space-around;"> <div style="text-align: center;"> <p>PLACED 500' IN ADVANCE OF FLAGGER.</p> </div> <div style="text-align: center;"> <p>PLACED 250' IN ADVANCE OF FLAGGER.</p> </div> </div> |
| | 3 | | <ul style="list-style-type: none"> - ALTERNATE THE FOLLOWING TWO SIGNS: - STARTING WITH "LOOSE GRAVEL" (W8-7) FOLLOWED BY "UNMARKED PAVEMENT". - PLACE INITIALLY AT THE CONSTRUCTION LIMITS AND SPACED 1 MILE APART THEREAFTER. - AT TEE INTERSECTIONS INSTALL INITIALLY 0.5 MILE FROM INTERSECTION AND SPACE 1 MILE APART THEREAFTER. | |
| | 4 | | <ul style="list-style-type: none"> - THESE ARE FOR -Y- LINES THAT ARE "THROUGH" ROADWAYS. DEAD END AND SUBDIVISION ROADS ARE NOT "THROUGH" ROADWAYS. - INSTALL 500' +/- FROM EACH -Y- LINE APPROACH AS SHOWN ABOVE. - FOR MULTIPLE -Y- LINES THAT ARE SEPARATED BY 0.25 MILES OR LESS, TREAT AS A SINGLE UNIT AND INSTALL WITHIN 500' OF EACH APPROACH. - A MAXIMUM OF 2 SIGN SETS PER MILE. DO NOT INSTALL WHEN -Y- LINES ARE WITHIN 0.5 MILES FROM "END ROAD WORK" SIGN. | |
| | 5 | | <ul style="list-style-type: none"> - PLACE 500' FOLLOWING THE END OF CONSTRUCTION LIMITS OR AS SHOWN WHEN WORK ENDS AT A 3-WAY TEE INTERSECTION. | |
| | <p>THE ABOVE SIGNS ARE ALL THAT ARE REQUIRED FOR A CONTRACTOR TO BEGIN A RESURFACING CONTRACT. ANY ADDITIONAL SIGNS REQUESTED BY NCDOT DIVISIONS SHALL BE INSTALLED WITHIN 7 BUSINESS DAYS OF THE START OF CONTRACT WORK.</p> | | | |

MAPS LESS THAN 2 MILES

FOR AST RESURFACING MAPS WITH CONSTRUCTION LIMITS LESS THAN 2 MILES IN LENGTH, USE A STATIONARY "LOOSE GRAVEL" SIGN AT THE BEGINNING CONSTRUCTION LIMIT FOLLOWED BY AN "UNMARKED PAVEMENT" SIGN MIDWAY THROUGH AND AN "END ROAD WORK" SIGN AT THE END CONSTRUCTION LIMIT.

ADVANCE WARNING SIGNS FOR 2-LANE ROADWAY ASPHALT SURFACE TREATMENT

5/12/2017 S:\TMD\WZTC\Resurfacing\2L2W & AST Resurfacing Details\Resurfacing_AdvWarn_2Ln - AST.dgn User:tkddis